

# AS LA SD

DIGITAL NEWSLETTER

SPRING 2024



WORLD  
LANDSCAPE  
ARCHITECTURE  
MONTH

AS  
LA  
SD

**WORLD  
LANDSCAPE  
ARCHITECTURE  
MONTH**

[asla-sandiego.org](http://asla-sandiego.org)

**VISION**

A world where the built and natural environments coexist in harmony and sustainable balance, where all peoples can express their diverse heritage and their individual desires to grow and thrive; and where we, as a profession, can substantially contribute to the process of achieving these ends.

**MISSION**

To lead, to educate and to participate in the careful stewardship, wise planning and artful design of our cultural and natural environments.

# IN THIS ISSUE

SPRING 2024



## 4 President's Message

JACKIE HIGGINS, ASLA



## 7 Kick-off Event RCP Block & Brick

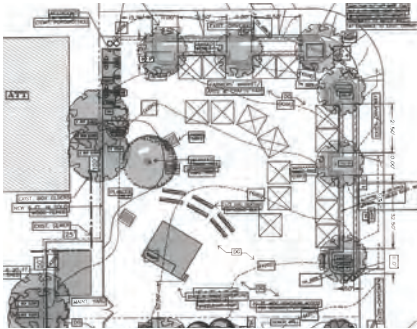

## 10 Community Grant Application

DIFAN CHAN, ASLA



## 18 Biodiversity in Our Backyards and Beyond

STEPHANIE GREEN, ASLA

DESIGN AWARDS UPDATE .....	<a href="#">7</a>
EMERGING PROFESSIONALS UPDATE .....	<a href="#">12</a>
CLARB LICENSURE CHANGES .....	<a href="#">14</a>
CUPPS UPDATE .....	<a href="#">15</a>
TRUSTEE UPDATE .....	<a href="#">17</a>
MEMBERSHIP UPDATE .....	<a href="#">20</a>

CCASLA UPDATE .....	<a href="#">22</a>
ASLASD UPCOMING EVENTS .....	<a href="#">24</a>
ASLA NATIONAL EXECUTIVE OFFICERS .....	<a href="#">26</a>
CCASLA EXECUTIVE BOARD .....	<a href="#">27</a>
SPONSORS .....	<a href="#">29</a>

# PRESIDENT'S MESSAGE



ABOUT THE AUTHOR  
**JACKIE HIGGINS, ASLA**  
CHAPTER PRESIDENT

## World Landscape Architecture Month (WLAM) is upon us!

There are many resources and engagement opportunities both locally and nationally to activate our profession.

[WLAM 2024 | asla.org](https://www.asla.org/wlam2024)

A couple local fun events this month are:

- » Thursday April 11th 5:30pm Native West **“Native plant talk”** 1849 Leon Ave. San Diego, CA, 92154.
- » Friday April 26th 9:00am **Arbor Day Tree planting** at Marston Point Balboa Park

ASLA National happening to be aware of:

On March 11, the White House released the [Budget of the U.S. Government for fiscal year 2025](https://www.whitehouse.gov/briefing-room/statements-releases/2023/03/11/). The proposal includes several increases compared to the fiscal year 2024 budget for climate change, biodiversity, parks, water, and transportation.

<https://dirt.asla.org/2024/03/18/president-advances-landscape-architecture-priorities-in-2025-budget-request/>

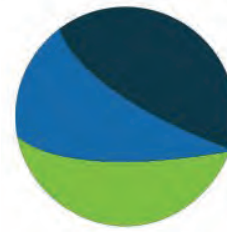

**WORLD  
LANDSCAPE  
ARCHITECTURE  
MONTH**

Also, The Freedom to Invest in Tomorrow's Workforce Act is a bill which would help cover the costs associated with being a licensed professional. This includes expenses related to the LARE, continuing education, renewal fees, and more. There is an opportunity to advocate for this at: <https://www.asla.org/advocate.aspx?vvsrc=%2fPetitions%2f4625%2fRespond>

ASLA San Diego will be participating on May 8th is Advocacy Day. Please look at the priorities for ASLA National which are based on the 2023-2024 biannual membership survey: <https://www.asla.org/GovernmentAffairs.aspx>

Heads Up! May 15, 2024 ASLA National launches the biannual membership survey, please keep an eye out for email and make sure you participate and make your voice heard regarding what is important to our members. It's only about 9 questions and takes about 2 minutes to complete. This sets the priorities for ASLA Advocacy for 2025-2026, please participate in the survey!



For those members that are interested, ASLA National compiles the latest list of potential project grant funding at: [Notice of Funding Opportunities | asla.org](https://www.asla.org/notice-of-funding-opportunities)

Thank you to Hunter Industries for an informative campus tour and hosting members for a happy hour on March 28th, 2024.

ASLA San Diego held our annual kickoff event on February 29 at RCP Block and Brick. It was a fun and educational evening with delicious food and drink. Members were able to chat with multiple vendors and see product demonstrations. View the event photos on [page 8](#).

Thanks so much to our generous kickoff event RCP Block & Brick! Landscape Architecture month is the best time to get involved. Please reach out to your local board members for open opportunities and look for more pop-up social events coming soon.

# NATIVE PLANT TALK

*with*

## NATIVE WEST NURSERY

APRIL 11, 2024 | 5:30-7:30PM

THE LITTLE BARN  
AT NATIVE WEST NURSERY

1849 LEON AVENUE, SAN DIEGO 92154

- LEARN WHY AND HOW TO SUCCESSFULLY SELECT, INSTALL & MAINTAIN CALIFORNIA NATIVE PLANTS
- NATIVE WEST WILL HIGHLIGHT A SELECTION OF HARDY NATIVE PLANT OPTIONS SURE TO BECOME YOUR NEW FAVORITES



RSVP BY APRIL 9  
[HTTPS://BPT.ME.6261822](https://bpt.me.6261822)



# BRINGING YOUR DESIGN INTENT TO REALITY SINCE 1905.



*Old Town San Diego State Historic Park (San Diego, CA) (Lithomosaics), Directors Place – Interior (San Diego, CA) (Lithocrete Sedimentary Walls & Epoxy Cement System), Directors Place – Exterior (San Diego, CA) (Lithocrete Sedimentary Walls & Lithocrete), The Boardwalk at Science Center (San Diego, CA) (Quarried Stone Finish), San Diego Symphony - The Rady Shell at Jacobs Park (San Diego, CA) (Quarried Stone & Honed Concrete), Sunnyvale Sedimentary Wall (Sunnyvale, CA) (Lithocrete Sedimentary Walls)*

For more than a century T.B. Penick & Sons, Inc. has been providing owners, architects, contractors, and specifiers like you, with the most advanced technologies in concrete materials and finishes. We enthusiastically support your vision, bringing quality, craft, and long-term value to those projects you wish to create. We look forward to working with you, ensuring that your design intent is accurately realized each and every step of the way.



858-558-1800 | [www.TBPenickICS.com](http://www.TBPenickICS.com)  
LITHOCRETE® TERRAZZO SITE CONCRETE

**T.B. PENICK  
& SONS, INC.**



# DESIGN AWARDS UPDATE



ABOUT THE AUTHOR

**Martin Armstrong, ASLA**

DESIGN AWARDS CHAIR

Thank you to all the firms who submitted a project of noteworthiness your firm has been working on, or your development team has completed during the past two years in anticipation of our upcoming design awards this June.

We received several exciting submissions in a variety of categories ranging from Residential, Unbuilt works, Pro-Bono, Public projects, and others. New design award categories introduced this year include Climate Champion Green Ribbon, Landscape Art, and Social Equity and Environmental Justice.

We didn't quite reach an all-time high on submissions but the quality we've seen thus far really exemplifies why America's Finest City continues to emerge as an international design centric destination. Our committee is narrowing down the selection process for the location and exact date so please keep an eye out for an e-mail and we look forward to seeing you all at the event.





Thanks to John Herd and Craig Finch at RCP Block and Brick for hosting our Annual Kickoff Event at their Escondido design center where upcoming programs were announced and the Board of Directors were introduced by Chapter President Jackie Higgins.



# KICK-OFF EVENT HOSTED BY RCP BLOCK & BRICK





THE 44TH ANNUAL  
**ASLA-SD GOLF TOURNAMENT**

**MONDAY, OCTOBER 28, 2024**  
**MADERAS GOLF CLUB**

**COURSE CHECK-IN: 9:30AM**  
**SHOT GUN START: 10:30AM**



**Proceeds benefit the ASLA-SD Community Grant Program**

**Player registration & sponsorship opportunities now available at**  
**<https://bit.ly/aslasd2024golf>**

# 2025 COMMUNITY GRANT APPLICATION



ABOUT THE AUTHOR  
**DIFAN CHEN, ASLA**  
VP COMMUNITY OUTREACH

The San Diego Chapter of the American Society of Landscape Architects (SDASLA) invites local non-profits to apply for the 2025 Community Grant of up to \$5,000 to design or construct landscape architectural improvements in San Diego County. Over 20 past grants have funded community improvement workshops, project design and construction, purchase of landscape amenities, and re-design and improvement of older community projects. Last year, we were pleased to award the grant to Julian Community Heritage Foundation with their project Julian Town Square.

The 2025 Grant Application will be posted on the Chapter website on the events page on June 1. Applicants are encouraged to review the complete guidelines before submitting their application packages on or before August 17 to ensure the application will be processed. The application deadline is August 17, 2024.

**COMMUNITY GRANT DETAILS**

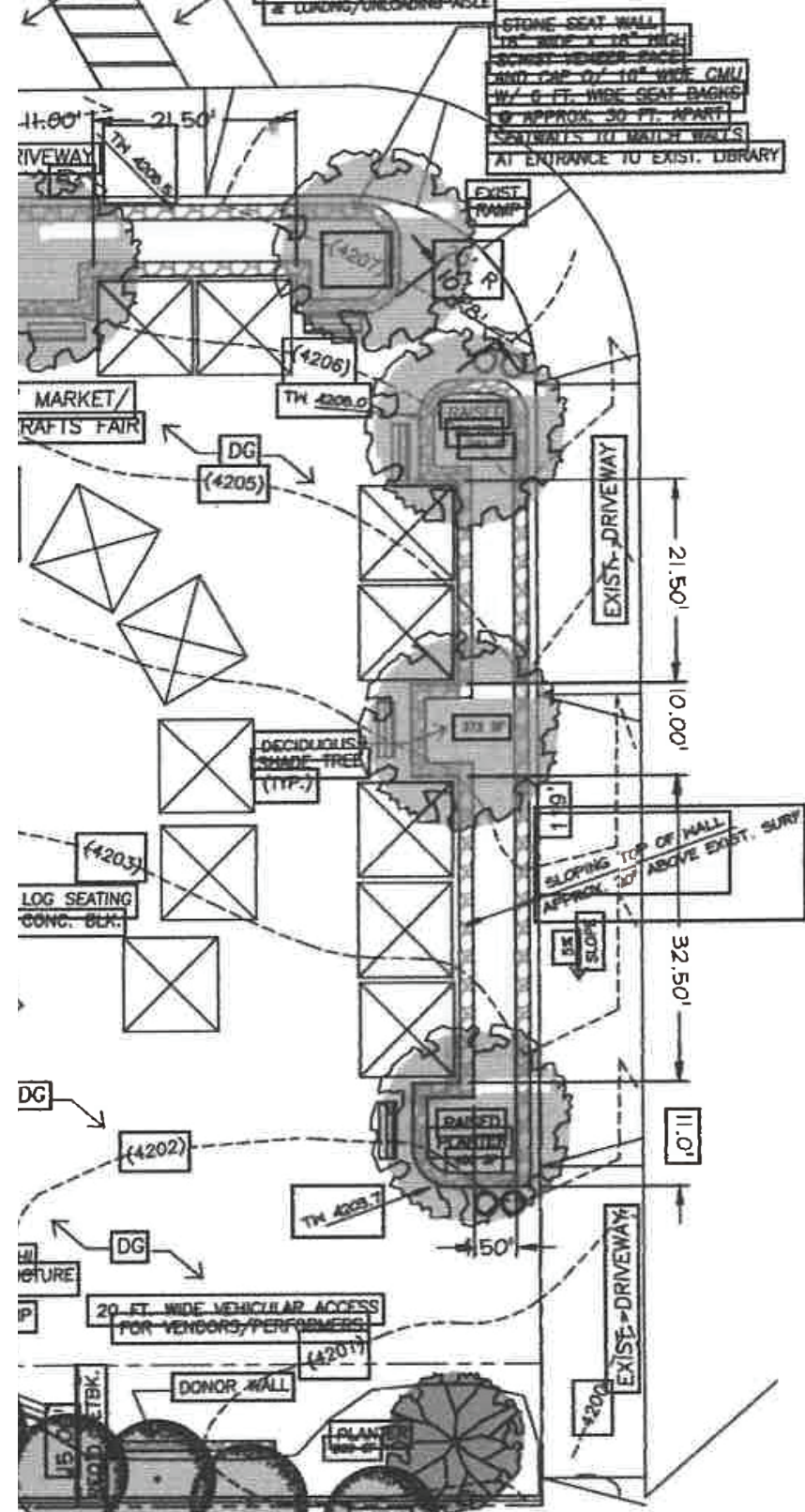





*Illuminates*

# THE NIGHT

The 1st Annual SDLA Illuminates the Night was a success! San Diego Lighting Associates invited 10 of its manufacturer partners to light the Japanese Friendship Garden at Balboa Park at night, showcasing their landscape light fixtures in a beautiful and unique garden environment. From pathways and greenery to building facades and koi ponds, more than 250 guests experienced different outdoor lighting designs.

Follow us on instagram @sdla\_landscape for landscape lighting inspiration or visit our landscape lighting landing page at [www.sandiegolighting.com/landscape-lighting](http://www.sandiegolighting.com/landscape-lighting).

[SDLA WEBSITE](http://www.sandiegolighting.com)





# EPC UPDATE



ABOUT THE AUTHOR  
**Gwen Stark, ASLA**  
EMERGING PROFESSIONALS  
CO- CHAIR



ABOUT THE AUTHOR  
**Fernanda Suarez, ASLA**  
EMERGING PROFESSIONALS  
CO- CHAIR



## HELLO EMERGING PROFESSIONALS!

In preparation for the April exam dates, we have been running LARE exam study groups for the past few months that our members have found very helpful. These study groups are a great way of creating a community of peers to share useful study resources and methods for the LARE exams which can be very intimidating to get started on. Meetings happen twice a week on Wednesday evenings (virtually) and Sunday mornings in person. We are looking forward to starting up these study groups as well as adding more review sessions in May to include even more of our members!

Good luck to all our members taking the LARE exam this April!

If you are interested in participating in these study groups or have any questions regarding EPC, please contact Gwen Stark or Fernanda Suarez.

[CONTACT GWEN](#)

[CONTACT FERNANDA](#)



# VOLUNTEERS NEEDED!

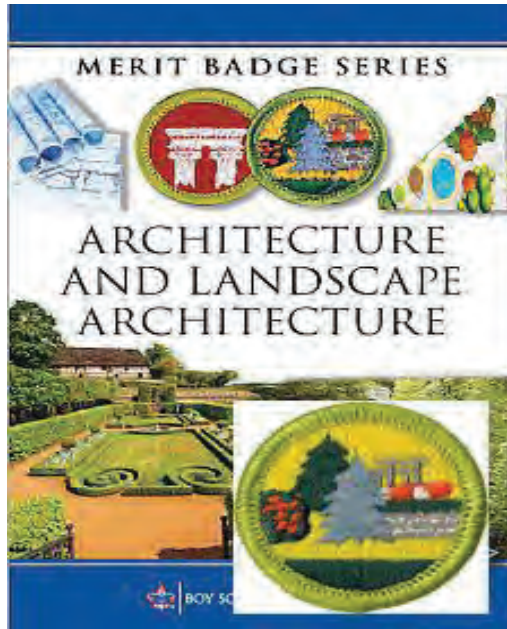

SAN DIEGO-IMPERIAL COUNCIL  
BOY SCOUTS OF AMERICA

## HELP TEACH LANDSCAPE ARCHITECTURE MERIT BADGE

San Diego Boy Scouts @ 'Merit Badge University'

Fun 'merit badge fair' event for Scouting - come share your passion for landscape architecture with the youth of Southern California.



Saturday  
May 11th

morning session  
8:00-12:00

afternoon session  
12:00-4:00

Point Loma Nazarene  
University  
Greek Theater

AM and PM shifts needed

Hot Lunch Provided!

Share your passion and  
give back

CONTACT:

Phil Armstrong, ASLA  
The Lightfoot Planning Group  
phil@lightfootpg.com  
760-692-1924

# CLARB LICENSURE CHANGES



ABOUT THE AUTHOR  
**Jon Wreschinsky, ASLA**  
LATC DIRECTOR, SAN DIEGO

**As of January 1, 2024, the Landscape Architecture Registration Examination (LARE) has been reformatted to better align with the areas of practice around which the exam is structured.** The new exam is organized to test the candidates' knowledge in four sections, which can now be taken in any order:

- » Inventory, Analysis, and Project Management
- » Planning and Design
- » Construction Documentation and Administration
- » Grading, Drainage, and Stormwater Management

The reorganization of the exam followed a multi-year assessment of landscape architecture practice in the United States and Canada and reflects efforts by CLARB and ASLA to address changes in practice tasks and other pertinent issues facing practitioners including climate change, public health, environmental resiliency, and evolving design & materials science.

California offers several pathways to qualify for examination and professional licensure. For the most up-to-date requirements, please refer to LATC's website: <https://www.latc.ca.gov/candidates/>. Once the LARE is completed, candidates will also have to take and pass the California Supplemental Exam (CSE). Information regarding the CSE can be found on the same website.

#### **Upcoming LARE cycles include:**

- » April 2024 (April 1-17, 2024)
- » August 2024 (July 29-August 14, 2024)
- » December 2024 (December 2-18, 2024)

Please refer to the Council of Landscape Architectural Registration Boards' (CLARB) website for more information: <https://www.clarb.org/take-the-exam/view-exam-dates-deadlines-and-fees>.

**CHECK OUT ASLA SOUTHERN CALIFORNIA'S LARE PREP WEBINARS – FREE TO MEMBERS!**



# CELEBRATING URBAN PUBLIC SPACES:

## JOIN US ON PARKING DAY SEPTEMBER 20, 2024



ABOUT THE AUTHOR  
**Wei Wang, ASLA**  
CUPPS CHAIR

---

### **Parking Day: Get ready to be part of something extraordinary!**

It is with great excitement that we invite you to participate in Park(ing) Day 2024, an annual event that empowers communities to reimagine urban spaces and advocate for more sustainable, people-centric city design. Originating in San Francisco in 2005, Park(ing) Day has since evolved into a global movement, inspiring creativity, engagement, and positive change in public spaces around the world. As members of the American Society of Landscape Architects (ASLA), we have a unique opportunity to lead by example and showcase the transformative power of landscape architecture in shaping vibrant, inclusive, and resilient communities.

### **Calling All Visionaries: Partner with ASLA in Shaping Park(ing) Day 2024!**

Are you ready to showcase your firm's creativity and passion for landscape architecture? We recognize the invaluable

contributions that landscape architecture firms bring to the table. Through innovative design, thoughtful planning, and a deep understanding of the natural and built environment, landscape architects have the power to shape the world around us. We invite your firm to join forces with ASLA in creating impactful Park(ing) Day installations that showcase the beauty and potential of our profession. Together, let's demonstrate the transformative power of landscape architecture and inspire positive change in our communities.

### **Unleash Your Creativity: Welcomes for All to Participate in Park(ing) Day 2024!**

Park(ing) Day is a celebration of creativity, collaboration, and community empowerment. Whether you're a seasoned landscape architect, a budding designer, a passionate student, or an engaged member of your community, there's a place for you in Park(ing) Day 2024. Join us in transforming ordinary parking spaces into extraordinary urban landscapes that spark joy, provoke thought, and inspire action. Together, let's demonstrate the power of design to create healthier, happier, and more vibrant cities for all.

### **Shape the Future: Your Input and Support Are Needed for Park(ing) Day 2024!**

As we embark on the journey towards Park(ing) Day 2024, we are in search of suggestions for potential locations and enthusiastic volunteers to bring our vision to life. Do you know of a parking space ripe for transformation? Are you eager to lend a helping hand in creating an unforgettable experience for our community? We invite you to share your ideas, offer your expertise, and join us in shaping the future of Park(ing) Day 2024. Together, let's turn parking spaces into places of joy, inspiration, and connection.



## Experience the Magic: ASLA Invites You to the Park(ing) Day 2024!

Park(ing) Day isn't just a one-day event—it's a celebration of creativity, collaboration, and community empowerment. Let's transform parking spaces into vibrant, people-centered places, sparking conversations and inspiring action. Join us on September 20th, 2024, and be part of this transformative movement. Together, let's showcase the power of landscape architecture to shape a brighter future for our cities and communities. Your participation is invaluable, and we can't wait to collaborate with you to create memorable installations that inspire positive change. Let's make Park(ing) Day 2024 a success together!



6TH ANNUAL ASLA-SAN DIEGO

# INSTAGRAM TAKEOVER

IN CELEBRATION OF  
WORLD LANDSCAPE  
ARCHITECTURE MONTH  
APRIL 2024



CUPSS



# TRUSTEE UPDATE



ABOUT THE AUTHOR  
**Patricia Trauth, ASLA**  
CHAPTER TRUSTEE

**How did many of you find out about the profession of landscape architecture in college or thereafter?** I have felt for many years that our biggest challenge is to increase our visibility as a profession. ASLA National has several programs that they have instituted or are participating in that provide exposure to younger generations.

The Future City Competition is a program started by DiscoverE, a nonprofit organization dedicated to providing global resources, programs, and connections between K-12 students and STEM professionals. This program is open to sixth, seventh, and eighth grade students around the world, the Future City Competition starts with a question – “How can we make the world a better place?”

The 32nd annual Future City Competition was held from September 2023 through February 2024. This year’s Future City challenge was to design a 100% electrically powered city with energy generated from sources that keep their citizens and the environment healthy and safe.

Teams are responsible for producing five deliverables:

- » **A Project Plan** – where students complete a four-part plan to help them organize their project,
- » **A City Essay** – in which teams have 1,500 words to describe their futuristic city and solutions to the Climate Change challenge,

- » **A City Model** – with only a \$100 budget, teams creatively repurpose recycled materials to build a scale model of their city,
- » **A City Presentation and Q&A session** – where teams have up to seven minutes to present their city.

Competition finals of nationwide regional winners were held during Engineer’s week - February 18 to 20, 2024. On Sunday, February 18, competing teams were judged from STEM and industry partners, including ASLA members Chloe Gillespie, Associate ASLA; Joseph Imamura, ASLA; and Kal Almo, ASLA.

As the first and only design group represented in the STEM competition, the **ASLA Special Award for Nature-Powered Solutions for Design and Equity** went to the Glen Hills Middle School in Glendale, Wisconsin. The team of 14 members won for their creative and futuristic design of their future city.

This is one of many programs ASLA National is promoting to get the word out about our profession! I would love to hear your thoughts on all things related to landscape architecture.

**CONTACT PATRICIA**



# BIODIVERSITY IN OUR BACKYARDS AND BEYOND



ABOUT THE AUTHOR

**Stephanie Green, ASLA**

CLIMATE ACTION COMMITTEE CHAIR

The winter rains have stirred our native plants from their dormancy, and now they burst forth with vibrant foliage and stunning floral displays. Spring invites us to rediscover the splendor of our native flora and marvel at the biodiversity within our local plant communities. I urge our members to immerse themselves in nature for inspiration and rejuvenation. Moreover, if you have the means or can volunteer your time, consider cultivating something, even soil. Take a patch of earth under your care and witness the diversity of life you can create below grade. Getting dirty is cleansing.

As we continue to navigate the ever-evolving challenges posed by climate change, it's crucial to emphasize the role of Landscape Architects not only as designers but as stewards of the environment. ASLA has set clear goals for global biodiversity, committing to advancing [the global movement to protect and restore at least 30 percent of terrestrial, coastal, and marine ecosystems by 2030 \(30 x 2030\)](#). To address the biodiversity crisis, the ASLA Climate Action Committee has been rebranded as the ASLA Climate and Biodiversity Action Committee (BCAC). Additionally, the ASLA Fund recently published new [peer-reviewed research](#) by Dr. Sohyun Park, ASLA, PhD, focusing on landscape architecture solutions to the biodiversity crisis.

Dr. Park's research underscores the remarkable efficacy of landscape architecture strategies in enhancing biodiversity. These strategies include incorporating native plants, supporting pollinators, conserving natural habitats, transforming gray infrastructure with green-blue solutions, and engaging in participatory design processes to forge partnerships with stakeholders and stewards. Dr. Park's findings align with the themes covered in [SDASLA CAC's February webinar on the Miyawaki Method of Afforestation](#), highlighting how small wooded lots can bolster regional biodiversity by reducing ecosystem fragmentation.

Lastly, I'd like to highlight that ASLA BCAC is offering a 9-part webinar series titled ["ASLA Biodiversity & Climate Action 101 for Landscape Architects,"](#) which is free for all ASLA members. These webinars, held monthly from February to October, delve into topics such as Material Selection for Low Carbon Design, Urban Ecology, and Biodiversity Metrics. In case you miss any session, the webinars are being recorded for later viewing.

**REGISTER FOR CLIMATE ACTION 101 WEBINAR SERIES**



# VOLUNTEER OPPORTUNITIES

## Get involved!

Volunteer on one of our committees or as part of the board! Meet other landscape architects and become part of our local landscape architecture community.

VOLUNTEER FORM



*leadership*  
grows here.



since 1979  
**dave bang**  
associates inc.   
▶ park+playground outfitters

▶ park+playground outfitters

## Designing For Impact ◀

Creating a truly impactful park + playground starts with understanding of your community's needs.

Then, we pull back the layers of objectives, fire up our creative engine and discover how to make what you've been imagining - a reality.

Remember, this project will be influencing lives for 20+ years so we want to get the design right!



**Community**



**Connection**



**Adventure**



VISIT US ONLINE

▶ 1.800.669.2585  
DAVEBANG.COM

# MEMBERSHIP UPDATE



ABOUT THE AUTHOR

**Tracy Hollingworth, CAE, MPA**

CHAPTER EXECUTIVE DIRECTOR

Thanks for your continued support of the ASLA San Diego chapter! Please feel free to reach out if you have any questions on your membership at [ASLASD@sbcglobal.net](mailto:ASLASD@sbcglobal.net).

## MEMBERSHIP ANNIVERSARIES

Congratulations to the following members for reaching membership milestones (member anniversaries in April through June are for continuing membership).

Watch for our Membership Satisfaction Survey which will ask members to let the Chapter know what they want more of (e.g. education, networking, project tours, collaboration with others in the design fields) and any areas where we can improve our communication with you and the public to emphasize the value of working with a landscape architect.



## 6 - 10 YEARS

Donna J. Tylor, ASLA  
Christopher William Stebbins, ASLA  
Devin Murphy, ASLA  
Difan Chen, ASLA  
Troy L. Vaughn, ASLA  
Brett Jeffrey Allen, ASLA

## 1 - 5 YEARS

Trista Silvia, Affiliate ASLA  
Philip Bronson Gann, Associate ASLA  
Yi Su, ASLA  
Michael S. Taylor, ASLA  
Myer Walden, Associate ASLA  
Michael Gallagher, Associate ASLA  
Brigitta Rehn, Affiliate ASLA



## ● 11 - 20 YEARS

Marcie Harris, ASLA  
Lisa Chestnut, ASLA  
Brad Lents, ASLA  
David Leonard, ASLA  
Alexander Nagel, ASLA  
Michael John V. Espiritu, ASLA  
Azlynn Hare, ASLA  
Ian Morris, ASLA  
Michael Brennan, ASLA  
Darren Jacobsen, ASLA  
Jonathan Avila, ASLA  
Jaime Sandoval, ASLA  
Amber Lake, ASLA  
Kenya Huezo, ASLA

## ● 21 - 30 YEARS

Martin J. Rosen, Honorary ASLA  
Nelly M. Chung, ASLA  
Michael Vail, ASLA  
Stephen J. Pomerence, ASLA  
Edward Whitehouse, ASLA  
Kathryn J. Kanaan, ASLA  
Michael E. Nichols, FASLA

## 31 + YEARS ●

Ralph W. Stone, ASLA  
Diana Womack Biegner, ASLA  
Todd N. Fry, ASLA  
David W. Reed, ASLA  
Barbara G. Gilman, ASLA  
William S. Burton, FASLA  
Sharon A. Singleton, ASLA

Michael Lee Singleton, FASLA  
Kurt William Carlson, ASLA  
Patrick W. Caughey, FASLA  
Robin Shifflet, ASLA  
Martin Poirier, FASLA  
Frank N. Brower, FASLA  
Christopher L. Langdon, ASLA

MEMBERSHIP

# CCASLA UPDATE NEW NONFUNCTIONAL TURF DESIGN LAW



ABOUT THE AUTHOR  
**Phil Armstrong, ASLA**  
CCASLA PRESIDENT

**HOAs are required to stop using potable water to irrigate nonfunctional turf or to remove such turf from common areas by the end of 2028.** Article by Kelly G. Richardson with the San Diego Union Tribune, February 27, 2024

The California Council of ASLA actively lobbied this issue when it appeared before the Water Parks and Wildlife Committee last year. The following is an article on the issue with the focus on impacts on Homeowner Associations.

Q: Can you address AB 1572, which will have a huge effect financially on our HOA?

A: Even though 2024 is expected to be a drought-free year, California is historically prone to periods of drought. On Oct. 13, 2023, the governor signed into law Assembly Bill 1572, creating a new Water Code Section 10608.14. (So now, in addition to Civil, Government, Corporations, and Vehicle Codes, there are also Water Code sections specifically affecting HOAs.)

This new statute requires various property owners, including common interest development associations, to remove "nonfunctional turf" or irrigate it with reclaimed water. HOAs are required to stop using potable water to irrigate nonfunctional turf or to remove such turf from common areas by the end of 2028.

"Nonfunctional turf" is defined by Water Code Section 10608.12 as "turf that is not functional turf." "Functional turf" is defined as "a ground cover surface of turf located in a recreational use area or community space. Turf enclosed by fencing or other barriers to permanently preclude human access for recreation or assembly is not functional turf." "Turf" means a "ground cover surface of mowed grass." (Title 23 California Code of Regulations Section 491).

The law allows HOAs to use potable water to irrigate trees and other non-turf plantings. HOAs must achieve compliance with this new law by Jan. 1, 2029. However, given the aforementioned definitions, only mowed grass areas that are enclosed and not accessible to residents appear to be defined as "nonfunctional turf."

Therefore, most HOAs probably will not be greatly impacted. However, mowed grass areas that are purely decorative and not available for residents to enjoy appear to fall under this restriction, so HOAs should plan on supplying such areas with reclaimed water or simply removing any mowed turf from the location.

HOAs with over 5,000 square feet of irrigated common area must every three years provide a certification of compliance to the State Water Board. Thousands of HOAs have that much



irrigated common area and will have to certify compliance, and the first certification is due on June 30, 2031.

The penalties for noncompliance are found in Water Code Section 1846, which provides for penalties of up to \$500 per day of violation. The state could also sue to enforce the law and collect the penalties.

While the law's goal of increasing potable water conservation is laudable, and although it won't substantially affect most HOAs, there is still the reporting requirement every three years to reckon with. Will the water board consider the failure to timely file a report to be a single \$500 violation, or will it consider each day to be a separate violation? Will the water board establish a form for these reports? Can they be submitted electronically? These are questions that remain to be sorted out in the coming years as the water board implements this statute.

If your HOA has more than 5,000 square feet of common area, the reporting deadline of June 30, 2031, should be calendared to avoid late filing.

Hopefully the impact on your HOA will not be as great as feared.

To read any California statute/law or bill, the official website is [leginfo.legislature.ca.gov](http://leginfo.legislature.ca.gov).

Richardson, Esq. is a Fellow of the College of Community Association Lawyers and Partner of Richardson Ober LLP, a California law firm known for community association advice. Submit column questions to [kelly@roattorneys.com](mailto:kelly@roattorneys.com). Past columns at [www.HOAHomefront.com](http://www.HOAHomefront.com).

## CCASLA Tracking Legislation in Second Year of Legislative Session

The following are bills being monitored by the Directors of the CA Council of ASLA.

BILL#	SUBJECT	POSITION	STATUS
<b>AB 996</b> (Low)	DCA: Continuing Education: Conflict of Interest Policy	WATCH	Sen Inactive
<b>AB 1573</b> (Friedman)	Prohibit Potable Water Use on Nonfunctional Turf	ReqAmend	Inactive File
<b>AB 1862</b> (Fong)	Engineering, land surveying, architecture: LLCs	Watch	Introduced
<b>AB 1912</b> (Pacheco)	Electricity: Mandated Programs	Watch	Asm Approp
<b>AB 2285</b> (Rendon)	Equitable outdoor access: 30x30 goal	Watch	AsmWaterPW
<b>AB 2440</b> (Reyes)	30x30 goal: Partnering State Agencies: Parks and Rec	Watch	Introduced
<b>AB 2600</b> (Calderon)	Urban Forestry: School Greening	Watch	AsmNatRes
<b>SB 802</b> (Roth)	Licensing Boards: Disqualification: Criminal Conviction	Watch	Asm B&P
<b>SB 1452</b> (Ashby)	Sunset Extension	Support	Introduced
<b>SB 1048</b> (Jones)	Planning Zoning: Site Plans	Watch	LocGov-Hrg 4/3
<b>SB 1091</b> (Menjivar)	School Facilities Greening	Support	Introduced



# UPCOMING EVENTS & MEETINGS

## APRIL

**1-30** WORLD LANDSCAPE ARCHITECTURE MONTH (WLAM)

**1-30** WLAM INSTAGRAM TAKEOVER  
**SIGN-UP VIA GOOGLE DOCS**

**11** NATIVE WEST NURSERY  
"NATIVE PLANT TALK"  
5:30PM - 7:30PM

**REGISTER BY APRIL 9TH**

**17** EXECUTIVE COMMITTEE MEETING  
6PM | ONLINE

**26** DESIGN AWARDS JURY DAY  
8AM - 5:30PM | LPA DESIGN STUDIO  
2765 TRUXTON RD, SAN DIEGO

## MAY

**2-3** ASLA NATIONAL MID-YEAR VIRTUAL MEETINGS

**9** SOCAL SHADE SAILS SPRING MIXER  
6PM - 8PM | 2048 ALDERGROVE AVE  
SUITE A, ESCONDIDO, CA

**11** BOY SCOUTS LANDSCAPE ARCHITECTURE MERIT BADGE EVENT  
8AM - 4PM | POINT LOMA NAZARENE UNIVERSITY

**VOLUNTEERS RSVP PHIL ARMSTRONG**

**15** EXECUTIVE COMMITTEE MEETING  
6PM | ONLINE

## JUNE

**1** COMMUNITY GRANT APPLICATIONS SENT DUE AUGUST 17

**EMAIL APPLICATIONS**

**15** EXECUTIVE COMMITTEE MEETING | 6PM  
LPA DESIGN STUDIOS

**20** DESIGN AWARDS EVENT  
TENTATIVE DATE/  
LOCATION TBD

**CHECK OUT OUR WEBSITE** FOR ALL OUR CURRENT & UPCOMING EVENTS

**ASLSD EVENTS**



# SPRING MIXER

JOIN US FOR  
MEXICAN FOOD  
DRINKS, MUSIC  
& NETWORKING

[HTTPS://BPT.ME/6274365](https://bpt.me/6274365)  
FREE WITH RSVP BY MAY 6

THURSDAY, MAY 9; 5:30-8P

SOCAL SHADE SAILS  
2048 ALDERGROVE AVE, STE A  
ESCONDIDO, 92029

SPONSORED BY:



# SAN DIEGO CHAPTER 2024 EXECUTIVE COMMITTEE

## **PRESIDENT**

**Jacqueline Higgins, ASLA**  
Forever Balboa Park  
619.331.1920

## **PRESIDENT ELECT – FUNDRAISING**

**Kathryn Kanaan, ASLA**  
KDA Landscape Architects  
619.840.5174

## **SECRETARY**

**Alexander Wade, ASLA**  
Rick Engineering  
619.291.0707

## **PAST PRESIDENT**

**Martin Armstrong, ASLA**  
Armstrong Land Development  
619.283.8818

## **VP COMMUNITY OUTREACH**

**Difan Chen, ASLA**  
KTUA Landscape Architecture & Planning  
607.793.8866

## **VP PROGRAMS/EDUCATION**

**Kenya Huevo, ASLA**  
LPA  
619.795.2555

## **PROGRAMS/SOCIAL CHAIR**

**Elissa Urbina, ASLA**  
GroundLevel  
619.984.4840

## **Erika Malcolm**

Park West  
949.285.0433

## **VP VISIBILITY/PUBLIC AFFAIRS**

**Ruoxi (Cisy) Cao, Associate ASLA**  
IDS Group

## **CHAPTER TRUSTEE**

**Patricia Trauth, ASLA**  
Rick Engineering Co.  
619.278.5656

## **CALIFORNIA COUNCIL OF ASLA**

**Phil Armstrong, ASLA**  
The Lightfoot Planning Group  
760.692.1924

## **Marty Schmidt, ASLA**

Environs  
619.232.7007, ext. 101

## **EMERGING PROFESSIONAL CO-CHAIRS**

**Gwen Stark, ASLA**  
KTUA  
619.294.4477

## **Fernanda Suarez, ASLA**

MIG  
619.682.3841

## **CLIMATE ACTION COMMITTEE**

**Stephanie Green, ASLA**  
Landscape Architect  
619.630.8730

## **GOLF COMMITTEE CO-CHAIRS**

**Kathryn Kanaan, ASLA**  
KDA Landscape Architects  
619.840.5174

**Gregg Roesink**  
Hunter Industries  
760.703.2474

## **PUBLIC SPACES ADVOCACY COMMITTEE**

**Wei Wang, ASLA**  
Van Dyke Landscape Architecture  
858.504.0392

## **EXECUTIVE DIRECTOR**

**Tracy Morgan Hollingworth**  
1050 Rosecrans St., Ste. B  
San Diego, CA 92106  
619.283.8818

## **ASLASD NEWSLETTER DESIGNER**

**Kari Cureton**  
Sarit + State Creative Studio  
619.318.3454



# ASLA NATIONAL EXECUTIVE OFFICERS

## **PRESIDENT**

SuLin Kotowicz, FASLA

## **PRESIDENT ELECT**

Kona Gray, FASLA

## **IMMEDIATE PAST PRESIDENT**

Emily O'Mahoney, FASLA

## **CEO/EVP**

Tony Carter-Conneen,  
Affiliate ASLA

## **VP COMMUNICATIONS**

Monique Bassey, ASLA

## **VP EDUCATION**

Ebru Ozer, FASLA

## **VP PROFESSIONAL PRACTICE**

Jean Senechal Biggs, ASLA

## **VP FINANCE**

Chris Della Vedova, FASLA

## **VP GOVERNMENT AFFAIRS**

Joy Kuebler, FASLA

## **VP MEMBERSHIP**

April Westcott, FASLA

## **SECRETARY**

Curt Millay, ASLA

## **TREASURER**

Michael D. O'Brien, Hon. ASLA

## **PARLIAMENTARIAN**

Susan Jacobson, ASLA

# CALIFORNIA COUNCIL OF ASLA 2024 EXECUTIVE BOARD

## **SIERRA CHAPTER**

Andrew Wickham, ASLA (Gov't Affairs)  
916.287.2326

## **Dalton La Voie, ASLA**

916.669.5913

## **SOUTHERN CALIFORNIA CHAPTER**

### **David Tatsumi**

949.453.9901

### **Stephanie Landregan, ASLA (Website)**

310.825.1735

## **SAN DIEGO CHAPTER**

### **Phil Armstrong, ASLA (President)**

760.415.24.26

### **Marty Schmidt, ASLA (Vice President)**

619.275.3003

## **NORTHERN CALIFORNIA CHAPTER**

### **Justin Richardson**

415.285.3614, x509

### **Brodie Hegg, ASLA (Treasurer)**

209.652.9399

## **LOBBYISTS**

### **Jason Ikerd**

Edelstein Gilbert Robson & Smith, LLC  
916.443.6400

## **LATC LIAISON**

### **Pamela Brief**

818.726.0456

## **LATC EO/PROGRAM MANAGER**

### **Laura Zuniga**

916.575.7230

## **CCASLA EXECUTIVE DIRECTOR**

### **Tracy Morgan Hollingworth**

619.283.8818

[cc-asla.org](http://cc-asla.org)



**High Quality**

**reproHAUS**

COMPUTER INNOVATION

TECH SERVICES

MANAGED PRINT

IT SERVICES

GRAND FORMAT SIGNAGE 3D PRINTING

HANNERS WINDOW GRAPHICS WAYFINDING CONSTRUCTION PROTOTYPING MODELING

BUILDING WRAPS WALL MURALS RETAIL 3D SIGNAGE CMYK FULL COLOR HIGH DEFINITION

FLOOR GRAPHICS TRADE SHOW ADVERTISING DECOR ENHANCED ACCURACY PHOTO REALISTIC

BILLBOARDS VEHICLE WRAPS COMMERCIAL REAL ESTATE ECO-FRIENDLY FAST TURNAROUND

ORDER ONLINE: WWW.REPROHAUS.NET



We are Southern California's resource for high quality outdoor products – representing the finest manufacturers in the outdoor recreation industry. Whether you are looking for outdoor shade systems, site furniture, playground equipment or surfacing, we are here to help. Discover and create the products you need to realize your vision. Contact us today for more information. **714.619.0100** or [coastrecreation.com](http://coastrecreation.com)





# THANK YOU TO OUR 2024 SPONSORS

# T.B. PENICK & SONS, INC.



AGRI-SERVICE ▶ ANOVA ▶ BENCHMARK LANDSCAPE ▶ GRO-POWER INC.  
NATIVE WEST ▶ SPRUCE AND GANDER ▶ THE LIGHTING ELEMENT

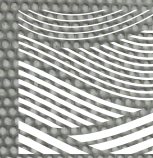

## Connect with Us



[asla-sandiego.org](http://asla-sandiego.org)

Mailing Address:  
1050 Rosecrans Street, Suite B  
San Diego, CA 92106

619.283.8818